

BNB Industries, Inc.

PO Box 963, Alvarado Texas 76009-0963 (mailing)
 2301 Webb Lynn Road, Arlington, Texas 76018 (mfg)
 Ph: 817-465-9226 E-mail: email@bnb-industries.com
 Fax 817-465-8305 Web Site: www.bnb-industries.com

**ROLLERS SHAFTS
 STYLE 2 - ROUND SHAFT - PIN RETAINED**

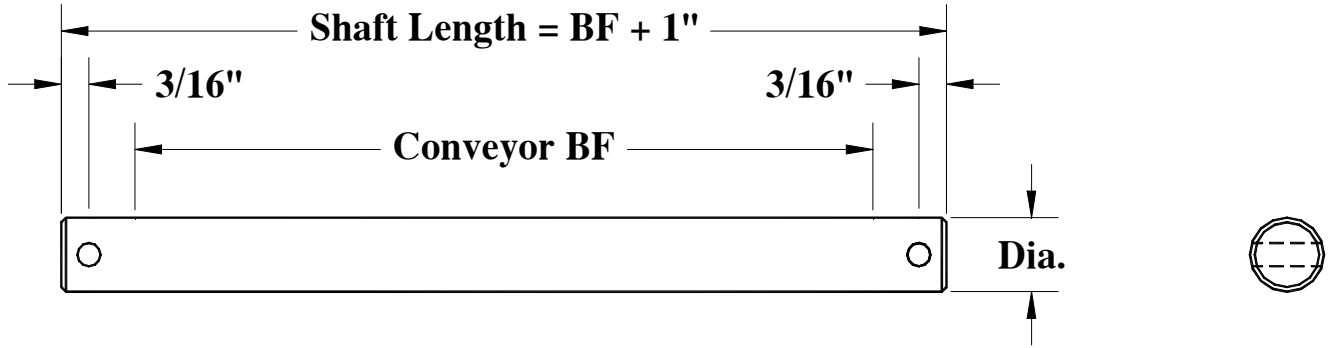

| SHAFT DIA. | SHAFT MATERIAL | SHAFT PART NUMBER |
|---|----------------|--------------------|
| 0.250 | 304 S.S. | SHAFT2084S * * * * |
| 0.250 | MILD STEEL | SHAFT208MS * * * * |
| 0.313 | 304 S.S. | SHAFT2104S * * * * |
| 0.313 | MILD STEEL | SHAFT210MS * * * * |
| 0.438 | 304 S.S. | SHAFT2144S * * * * |
| 0.438 | MILD STEEL | SHAFT214MS * * * * |
| 0.500 | 304 S.S. | SHAFT2164S * * * * |
| 0.500 | MILD STEEL | SHAFT216MS * * * * |
| 0.625 | 304 S.S. | SHAFT2204S * * * * |
| 0.625 | MILD STEEL | SHAFT220MS * * * * |
| 0.750 | 304 S.S. | SHAFT2244S * * * * |
| 0.750 | MILD STEEL | SHAFT224MS * * * * |
| 1.000 | 304 S.S. | SHAFT2324S * * * * |
| 1.000 | MILD STEEL | SHAFT232MS * * * * |
| 1.188 | 304 S.S. | SHAFT2384S * * * * |
| 1.188 | MILD STEEL | SHAFT238MS * * * * |
| 1.250 | 304 S.S. | SHAFT2404S * * * * |
| 1.250 | MILD STEEL | SHAFT240MS * * * * |
| 1.438 | 304 S.S. | SHAFT2464S * * * * |
| 1.438 | MILD STEEL | SHAFT246MS * * * * |
| Contact BNB for Special Sizes & Material not listed | | |

| * * * * SHAFT LENGTH CODES (USED TO COMPLETE SHAFT PART NUMBER) | | | |
|---|-------------|-------------|-------------|
| 01 = 1/32" | 09 = 9/32" | 17 = 17/32" | 25 = 25/32" |
| 02 = 1/16" | 10 = 5/16" | 18 = 9/16" | 26 = 13/16" |
| 03 = 3/32" | 11 = 11/32" | 19 = 19/32" | 27 = 27/32" |
| 04 = 1/8" | 12 = 3/8" | 20 = 5/8" | 28 = 7/8" |
| 05 = 5/32" | 13 = 13/32" | 21 = 21/32" | 29 = 29/32" |
| 06 = 3/16" | 14 = 7/16" | 22 = 11/16" | 30 = 15/16" |
| 07 = 7/32" | 15 = 15/32" | 23 = 23/32" | 31 = 31/32" |
| 08 = 1/4" | 16 = 1/2" | 24 = 3/4" | 32 = 1" |
| First two digits of length code is whole inches. Second two digits of length code is based on 32's of an inch increments. Example: Length is 15-1/2" = 1516. | | | |